

PRODUCT DATA SHEET

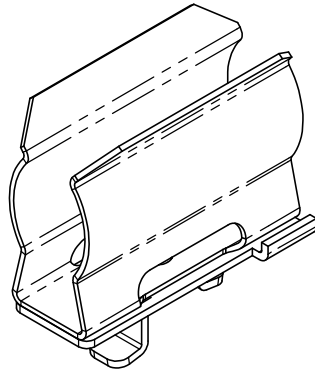
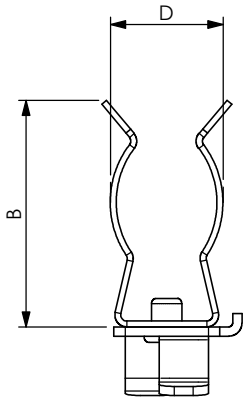

A) SPECIFICATIONS

Stainless steel

B) PACKAGING INFORMATION

Packing in boxes.
Label indicating:
product code, article, quantity,
production batch,
FIMO logo and figure.
(Customer code on request).

ARTICLE	FOR CABLES	N° CABLES	B	D	FOR SECTIONS	BAG	BOX	WEIGHT
EMC-C 13	1/4" - 1/2"S	1	33	∅ 9 ÷ 13		20	100	20
EMC-C 20	1/2" - 3/8"	1	40	∅ 15 ÷ 20		20	100	20
EMC-C 30	7/8"S - 7/8" - 7/8"M	1	52	∅ 27 ÷ 30		20	100	40
EMC-C 52	1.1/4" - 1.5/8"	1	78	∅ 39 ÷ 52		20	100	70

RI	DATE	DR	DATE	AP	Description:
02					<p>EMC - C Snap-in Hangers</p> <p>For Electrical Cables and Pipes</p>
01					
00	29/01/16	G.S.	29/01/16	A.V.	
1 ST EMISSION					
					<p>Use:</p> <p>Hooking on PCI 40x22 sections</p>